

SITE EXTENT (AS PER PATTA) = 663 Sq.M ✓
 TOTAL NO. OF PLOTS = 1 No

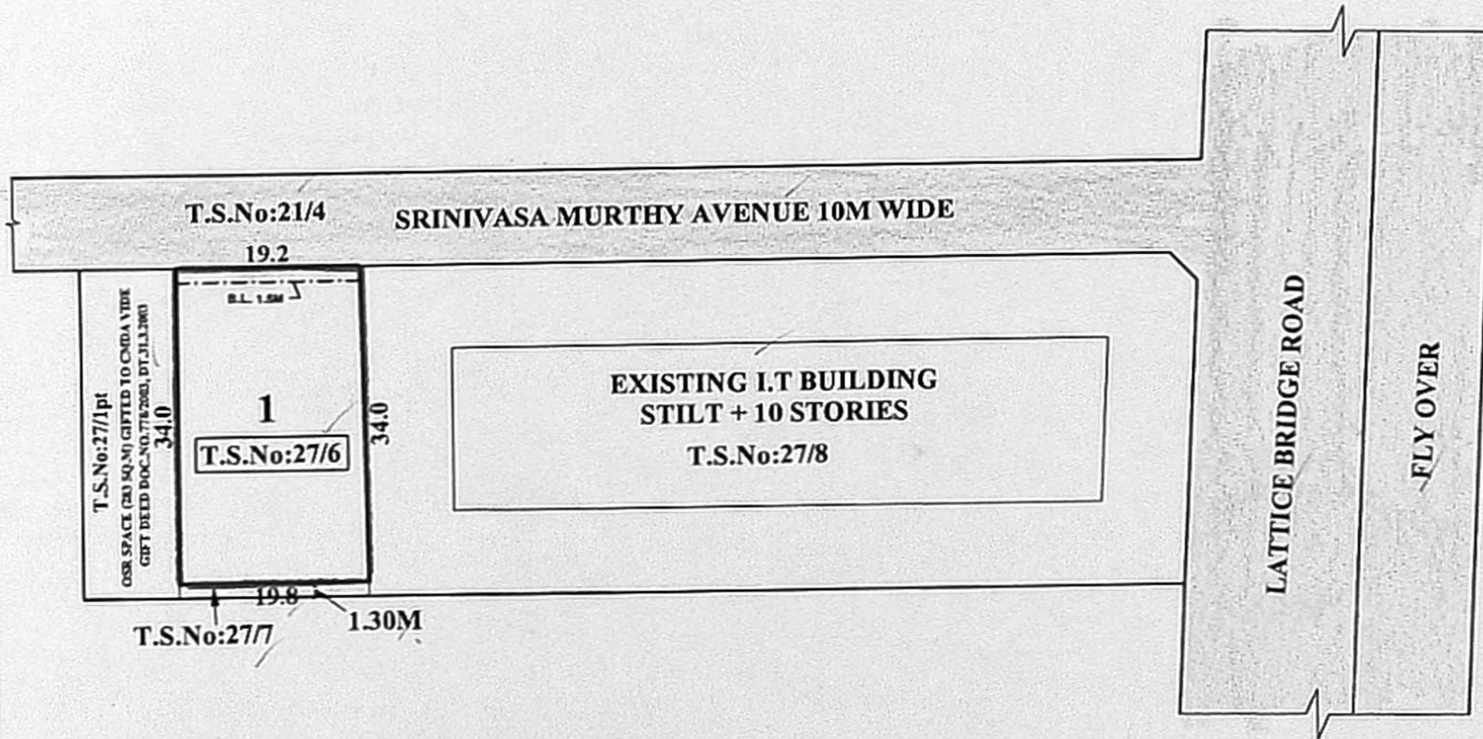

CONDITIONS:

DR RULE NO: 29 (11)

THE COST OF LAYING IMPROVEMENTS TO THE SYSTEMS INRESPECT OF ROAD, WATER SUPPLY, SEWERAGE, DRAINAGE OR ELECTRIC POWER SUPPLY THAT MAY BE REQUIRED AS ASSESSED BY THE COMPETENT AUTHORITY, SHALL BE BORNE BY THE APPLICANT.

LEGEND:

- SITE BOUNDARY
- EXISTING ROAD

CONDITIONS:

THE LAYOUT APPROVED IS VALID SUBJECT TO OBTAINING SANCTION FROM THE LOCAL BODY CONCERNED.

P.P.D NO: 42
 L.O 2017

APPROVED

VIDE LETTER NO : L1/9001/2016

DATE : 18/09/2017

S. Ramesh
 18/09/2017
 FOR MEMBER SECRETARY
 CHENNAI METROPOLITAN
 DEVELOPMENT AUTHORITY 4/5

S. Ramesh
 15/09/17
 PREPARED BY P.A-IV (S.M)

S. Rajalakshmi
 15/9/17
 CHECKED BY P.A.I (S.R)

A.P. (S.A)
 15/09/17
 A.P.(S.A)

CORPORATION OF CHENNAI, DIVISION-175, ZONE-XIII

SKETCH SHOWING THE REGULARIZATION OF THE SUB-DIVISION OF THE PROPERTY COMPRISED IN T.S.No: 27/6, BLOCK NO.40 (OLD S.Nos: 13/3 & 14/3) OF KOTTUR VILLAGE.

SCALE : 1:800 (ALL MEASUREMENTS ARE IN METRE.)

